

AI + DIGITAL TECHNOLOGIES

WORKTECH

W

EXPLORE THE FUTURE OF WORK POWERED BY INTELLIGENCE & INNOVATION

TUESDAY 9TH JUNE 2026

META, KINGS CROSS, LONDON

HOST PARTNER



PLATINUM & VIP DINNER SPONSOR



SILVER SPONSOR



BESPOKE SPONSORS



MEDIA PARTNERS



SUPPORTED BY





Caroline Bell

Conference Producer,
WORKTECH Events

A warm welcome to WORKTECH26 AI + Digital Technologies

WORKTECH AI and Digital Technologies London is the new flagship event in the WORKTECH series, designed for workplace, IT, and digital transformation leaders exploring how artificial intelligence and emerging digital tools are revolutionizing the world of work.

Combining strategy, innovation, and real-world insight, the event will showcase cutting-edge thinking on how technology can create more intelligent, sustainable, and human-centric workplaces.

Join other senior professionals from real estate, facilities, HR, technology, executive management, architecture, design and professional advisors to listen to global thought leaders, further their knowledge and share best practise and expertise.

Alongside the conference, we will have a curated innovations exhibition taking place in the breakout areas for attendees to meet with our education partners, complementing learning during the day.

On the day, there will be networking breaks, allowing attendees time to meet the other participants.

We hope you will be able to join us and we are looking forward to welcoming you to the event on 9th June.

Warmest regards,
Caroline

CONTENTS



SPEAKERS



SESSIONS



CONFERENCE AGENDA

A photograph of a woman in a red and white patterned jacket talking to a man in a dark suit. They are in a conference setting with other people in the background.

VENUE



WHO ATTENDS



KEY INFORMATION

MEET THE SPEAKERS



WORKTECH26 AI + Digital Technologies will attract some of the biggest and brightest names to debate, discuss, and divulge the latest thinking on the future of work and the workplace.

The conference will feature leading international thinkers from industry and academia.

Through interdisciplinary speakers and learning experience, we focus on bringing cutting edge ideas and inspiration to the workplace community to enhance creativity and move thinking forward. Instead of focusing on peer to peer innovation through imitation, we aim to curate a unique programme, bringing together experts in the fields of people, place and technology and relevant adjacencies to reflect on the future of work and workplace.

Alongside the conference series, the WORKTECH Academy knowledge hub explores the future of work through six key themes: people, place, technology, design, culture and innovation. Creating leading commentary, research and publications that places scientific research at the heart of key business problems. www.worktechacademy.com

List of speakers

Michelle Andrew, **Meesh**
Gabriela Bialowska, **WORKTECH Academy**
Karen Burns, **Fyma**
Nicky Chapman, **Microsoft**
Emy Cragoe, **ORI**
Rob Cookson, **Meta**
Sofonias Demasas, **Bayer**
Simon Durkin, **Urban Land Institute**
Jens Eriksvik, **Algorithmia**
Rob Garlick, **Professor, Consultant, Coach & Author**
Harish Krishna, **Director, Engineering Meta**
Arthur Olney, **M&G**
Toby Ogden, **President, FORA**
Matt Potter, **HSBC**
Elisa Ronka, **Johnson Controls**
Philip Ross, **Ungroup & Cordless Group**
Andrew Targell, **JLL**
Stephen Walker, **Aberdeen Investments**
Christian Wong, **Zopa Bank**
Ibrahim Yate, **JLL**



Nicky Chapman, AI Powered Workplace Program Lead | Teams Engineering (UKI & Benelux), Microsoft



Sofonias Demsas, Head of Global Governance, Standards, Best Practice - Corporate Real Estate, Bayer



Simon Durkin, CEO, Urban Land Institute



Rob Garlick, AI, Work & Pro-Human Leadership Professor, Consultant, Coach and Author



Andy Targell, Real Estate Technology Strategy, JLL



Christian Wong, Senior Director, Strategic Initiatives, Zopa Bank

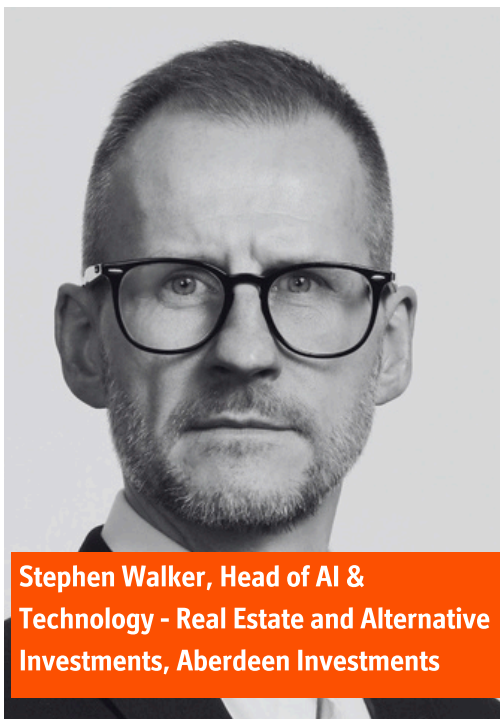

Stephen Walker, Head of AI & Technology - Real Estate and Alternative Investments, Aberdeen Investments



**Karen Burns
CEO & Co-Founder, Fyma**

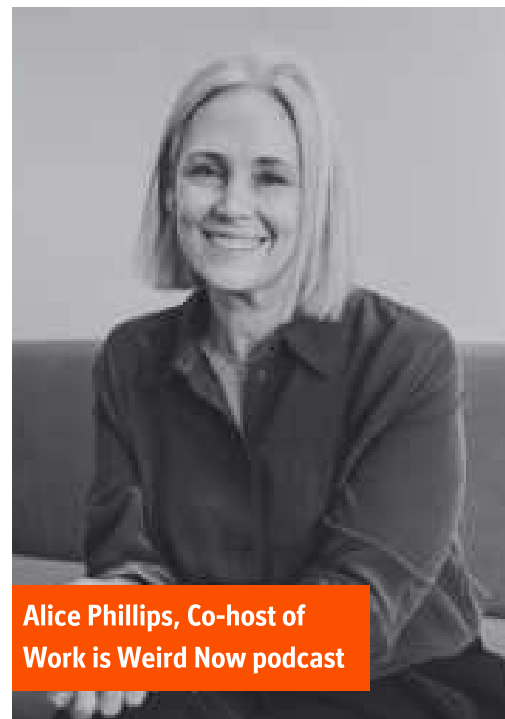

Alice Phillips, Co-host of Work is Weird Now podcast

SESSION HIGHLIGHTS



Key themes we will be discussing at this event include:

[The Intelligent Workplace: Redefining Work in an Age of Synthetic Capability](#)

AI is no longer an add-on to workplace strategy – it's becoming the operating system of the modern enterprise. Organisations are moving from experimenting with tools to architecting truly intelligent workplaces where data, automation, and human ingenuity converge in real time. This theme sets the stage for a London audience under pressure to innovate fast while staying grounded in trust, ethics, sustainability, and performance.

[Intelligent Workflows & Digital Productivity](#)

AI is rapidly reshaping the flow of work – not just speeding it up, but making it fundamentally smarter and more intuitive. From copilots and generative assistants embedded in everyday tasks to automated workflows that surface the right data at the right moment, organisations are moving toward adaptive, personalised work experiences that respond to individual needs and team dynamics. This theme explores how intelligent tools unlock better decisions, smoother processes, and a more fluid digital workplace built for real productivity gains.

[Designing the Digital Workplace](#)

As work becomes increasingly hybrid and data-rich, organisations are rethinking how physical and digital environments intersect. From workplace apps and integrated platforms to digital twins that mirror real-time behaviour, experience design is shifting toward environments that respond intelligently to people and the work they're doing. This theme looks at the convergence of UX, data, and spatial design – exploring how we build workplaces shaped as much by human needs as by the information flowing through them.

[Human Experience & Change](#)

As AI reshapes work at every level, the real differentiator becomes how people experience and adapt to this shift. From digital employee experience and new behavioural norms to the evolving dynamics of human-machine collaboration, organisations are being pushed to build cultures grounded in trust, transparency, and responsible adoption. This theme explores the leadership, ethics, and skills required to guide teams through AI-driven transformation – ensuring that technology empowers people rather than overwhelms them.

KEY THEMES

**THE INTELLIGENT WORKPLACE:
REDEFINING WORK IN AN AGE OF
SYNTHETIC CAPABILITY**

**INTELLIGENT WORKFLOWS &
DIGITAL PRODUCTIVITY**

**DESIGNING THE DIGITAL
WORKPLACE**

HUMAN EXPERIENCE & CHANGE

08:30 REGISTRATION

09:00 CHAIRPERSONS WELCOME

Emy Cragoe, [Managing Director, ORI](#) and
Jens Eriksvik, [CEO, Algorithmia](#) Welcome from our Chairs.



09:05 HOST WELCOME ADDRESS

Rob Cookson, [Vice President of Global Real Estate and Facilities, Meta](#) A brief introduction to Meta Kings Cross.



THE INTELLIGENT WORKPLACE: REDEFINING WORK IN AN AGE OF SYNTHETIC CAPABILITY

AI is no longer an add-on to workplace strategy — it's becoming the operating system of the modern enterprise. Organisations are moving from experimenting with tools to architecting truly intelligent workplaces where data, automation, and human ingenuity converge in real time. This theme sets the stage for a London audience under pressure to innovate fast while staying grounded in trust, ethics, sustainability, and performance.

09:15 AI: ANARCHY OR ABUNDANCE? WHY THE FUTURE OF WORK WILL BE DECIDED BY LEADERSHIP CHOICES, NOT TECHNOLOGY

Rob Garlick, [AI, Work & Pro-Human Leadership Professor, Consultant, Coach and Author](#)



As AI moves from promise to impact, leaders are no longer speculating about the future of work, they are managing disruption in real time. From high-profile workforce reductions to the rise of “smaller, flatter, intelligence-native” organisations, the shift is accelerating faster than most institutions, and people, can absorb. This session explores the defining tension of the AI era: are we building a future of shared abundance, or drifting toward economic and social fracture? Challenging the dominant narrative of efficiency and profit, we examine the rise of being pro-machine but not pro-people, the growing danger of a societal backlash against technology, and the uncomfortable reality that strong corporate performance no longer guarantees job security.

This session will push leaders to confront critical questions:

- What does responsible leadership look like when AI displaces roles faster than we can redesign them?
- How do we bring people with us — not leave them behind?
- Should we rethink taxation, value distribution, and the social contract in an AI-driven economy?
- And how do we avoid an “economic singularity” where wealth and power concentrate beyond control?

09:40 THE WORLD'S SMARTEST WORKPLACE: INSIDE JP MORGAN'S 270 PARK AVENUE

Philip Ross, [CEO and Founder, Unwork](#)



JPMorgan Chase's new HQ at 270 Park Avenue is being positioned as the world's smartest building—a bold statement in an era of hybrid work. In this talk, Philip explores how AI, sensors and intelligent systems are reshaping the corporate workplace, using this landmark project as a case study. Beyond the technology, he challenges whether flagship headquarters still make sense, what truly drives performance and experience, and what lessons organisations can take—without billion-dollar budgets. A fast-paced, provocative look at what the future workplace really demands.

09:55 FROM INTEGRATION TO INTELLIGENCE: AI, WORKPLACE STRATEGY AND THE HUMAN EXPERIENCE

Rob Cookson, [Vice President of Global Real Estate and Facilities, Meta](#) and Philip Ross, [CEO and Founder, Ungroup and Cordless Group](#)



In this fireside chat, Rob Cookson joins Philip Ross to explore how AI is reshaping workplace and real estate strategy at scale. The conversation looks beyond automation and dashboards to examine AI as a decision-making engine — enabling predictive, not reactive, approaches to space, operations and employee experience. Topics include AI-driven workplace optimisation, anticipatory portfolio strategy, balancing data with human insight, and the practical realities of readiness, governance and scale. A grounded discussion on what's genuinely changing — and what leaders need to get right next.

10:25 NETWORKING AND COFFEE BREAK

THE INTELLIGENT WORKPLACE: REDEFINING WORK IN AN AGE OF SYNTHETIC CAPABILITY

AI is rapidly reshaping the flow of work — not just speeding it up, but making it fundamentally smarter and more intuitive. From copilots and generative assistants embedded in everyday tasks to automated workflows that surface the right data at the right moment, organisations are moving toward adaptive, personalised work experiences that respond to individual needs and team dynamics. This theme explores how intelligent tools unlock better decisions, smoother processes, and a more fluid digital workplace built for real productivity gains

10:50 FROM FACILITY MANAGERS TO AI ORCHESTRATORS: REDEFINING FM'S ROLE IN THE AUTONOMOUS BUILDING ERA

Ibrahim Yate, [Senior Research Analyst, JLL](#), Andrew Targell, [Managing Director, Technology Advisory, JLL](#)

By 2035, traditional building management will evolve into sophisticated orchestration of AI-driven systems and autonomous technologies. This presentation explores JLL's vision for the future of FM, where professionals transition from reactive maintenance to proactive ecosystem governance. Drawing from real-world client implementations and frontline innovation insights, we'll examine how forward-thinking organizations are positioning FM teams as the strategic architects who establish operational parameters for self-reporting assets and autonomous building systems. Discover what it truly means to deliver a future-ready occupant experience, where seamless technology integration creates environments that anticipate needs, optimize performance, and enhance human productivity. The future belongs to those who can orchestrate intelligence, not just manage infrastructure.

SESSION TO BE ANNOUNCED

Speaker to be announced

Session to be announced

WORKTECH ACADEMY

11:15 MEET YOUR NEW TEAMMATE: DESIGNING THE AGENTIC AI WORKFORCE

Elisa Ronka, [Managing Director - Digital EMEA, Johnson Controls](#)



AI is no longer a system employees log into — it's becoming an active teammate. In workplace and facility operations, agentic AI is moving beyond dashboards to take action, coordinate workflows, and intervene only when human judgment is needed.

This session explores what it truly means to treat AI agents as new joiners from day one. Drawing on real enterprise deployments, Elisa will examine how proactive AI is reshaping employee experience, operational resilience, and building performance — and what leaders must redesign now to stay ahead of autonomous operations.

11:40 AI AND THE INTELLIGENT WORKPLACE AND TEAM RELATIONSHIPS IN THE WORKPLACE

Nicky Chapman, [UKI & Benelux AI Powered Workplace Program Lead | Teams Engineering, Microsoft](#)



Artificial intelligence is redefining how people collaborate, communicate, and make decisions at work. As hybrid environments mature, AI-powered meeting platforms and intelligent spaces are becoming central to productive, inclusive collaboration. This session explores how AI is transforming the modern workplace, the emerging role of intelligent meeting rooms, and how organisations can prepare for the next generation of digital work—improving meeting equity, unlocking organisational knowledge, and enabling more seamless collaboration across in-person and remote teams.

12:05 INNOVATION PLATFORM

Speaker to be announced.

Session to be announced.



12:15 SESSION TO BE ANNOUNCED

Speaker to be announced.

Session to be announced.

12:20 SESSION TO BE ANNOUNCED

Speaker to be announced.

Session to be announced.

12:40 NETWORKING AND LUNCH

DESIGNING THE DIGITAL WORKPLACE

As work becomes increasingly hybrid and data-rich, organisations are rethinking how physical and digital environments intersect. From workplace apps and integrated platforms to digital twins that mirror real-time behaviour, experience design is shifting toward environments that respond intelligently to people and the work they're doing. This theme looks at the convergence of UX, data, and spatial design — exploring how we build workplaces shaped as much by human needs as by the information flowing through them.

13:50 RETHINKING THE LIFE SCIENCES WORKPLACE: DESIGN IN THE AGE OF AI

Sofonias Demsas, [Head of Global Governance, Standards, Best Practice for Corporate Real Estate Bayer](#)



Artificial intelligence is rapidly reshaping how organisations operate, collaborate, and make decisions. Across the life sciences sector, AI may be influencing everything from research and development to manufacturing, commercial operations, and corporate functions. As digital platforms with advanced analytics, and AI-driven workflows could become embedded in everyday work, the relationship between people, place, and technology will be redefined. This session explores what these changes mean for workplace strategy and corporate real estate. How should organisations design environments that support new ways of working, enable collaboration across physical and digital settings, and remain adaptable as AI continues to transform the business landscape?

14:05 EXPERT PANEL: SESSION TO BE ANNOUNCED

Speakers to be confirmed.

Session to be announced

14:30 SESSION TO BE ANNOUNCED

Speakers to be confirmed.

Session to be announced

14:35 SESSION TO BE ANNOUNCED

Speakers to be confirmed.

Session to be announced

15:00 NETWORKING AND COFFEE BREAK

HUMAN EXPERIENCE & CHANGE

As AI reshapes work at every level, the real differentiator becomes how people experience and adapt to this shift. From digital employee experience and new behavioural norms to the evolving dynamics of human-machine collaboration, organisations are being pushed to build cultures grounded in trust, transparency, and responsible adoption. This theme explores the leadership, ethics, and skills required to guide teams through AI-driven transformation — ensuring that technology empowers people rather than overwhelms them

15:25 EXPERT PANEL: WHO OWNS THE AI WAY OF WORKING? GOVERNANCE, CHANGE AND THE REALITY GAP

Moderated by: Michelle Andrew, [Founder Meesh](#). Speakers: Karen Burns, [CEO and Co-Founder, Fyma and AI Speaker & Executive Education Contributor, University of Cambridge \(Cambridge Judge Business School\)](#), Simon Durkin, [CEO, Urban Land Institute](#), Stephen Walker, [Head of AI + Technology Aberdeen Investments](#), Christian Wong, [Senior Director, Strategic Initiatives, Zopa Bank](#)

AI adoption isn't a technology problem — it's a change problem. This panel cuts through hype to tackle the hardest question organisations face: who actually owns the AI strategy, and how do you make it stick in day-to-day work? With perspectives spanning HR, IT, digital, operations and the built environment, the discussion explores governance models, AI squads, data ethics, and cross-functional accountability. From smart spaces and sustainability myths to how AI is reshaping job roles and architectural practice, this session focuses on practical leadership decisions — not experiments — and what it really takes to change how work gets done.



16:05 WORKING WITH AI AS YOUR NEW COLLEAGUE

Led by Work is Weird Now (WIWN) podcast founders Dan Emery and Alice Phillips. [WIWN is a forum partner, bringing their distinctive lens on the weird, fast-evolving future of work](#)



As AI shifts from abstract concept to everyday co-worker, organisations are grappling with what it really means to collaborate with non-human intelligence. This immersive session invites participants to explore that frontier through live, real-world dilemmas drawn from work and workplace design. Across rotating discussion tables, attendees will tackle challenges spanning productivity, culture, ethics, and the built environment. An “invisible AI colleague” will operate in the background, synthesising emerging themes in real time and pressure-testing the group’s conclusions. The process reveals where AI can genuinely augment human capability and where human judgement must hold the line. Expect a dynamic, collective-intelligence experience that transforms AI from buzzword to practical collaborator.

16:35 CLOSING REMARKS

Emy Cragoe, [Managing Director, ORI](#) and [Jens Eriksvik, CEO, Algorithmia](#)

Final thoughts from our Chair.



16:45 NETWORKING AND DRINKS

CONFERENCE LOCATION

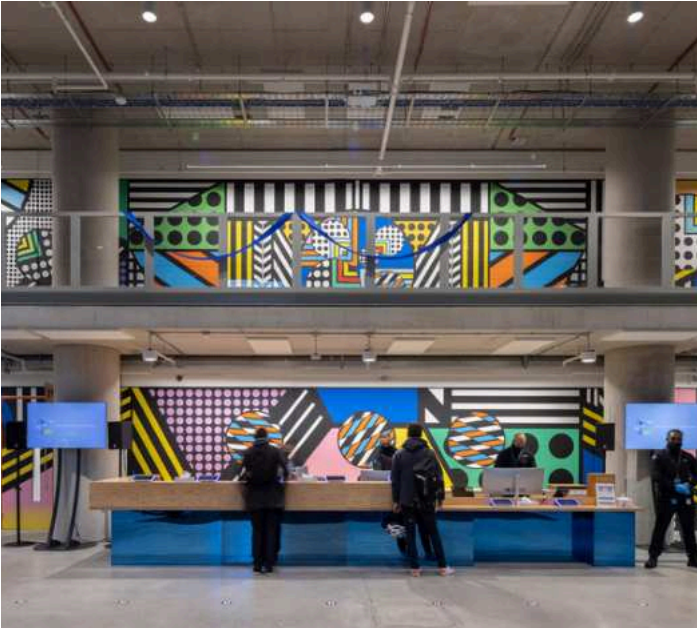

Meta, Kings Cross, London

WORKTECH26 AI + Digital Technologies is proudly hosted by Meta at 11-21 Canal Reach, London.

The offices are a substantial investment in London with more than 620,000 square feet of office space and almost 5,000 workstations. Part of the carbon neutral King's Cross estate, the offices were constructed using leading sustainable building techniques and are being entirely supplied by green gas. They are home to engineering teams working on Instagram, Reality Labs (which is building the future of connection within virtual and augmented reality), Workplace, and Ads & Business Products.

London is already Meta's largest engineering hub outside the US with more than 4,000 employees based at offices in Brock Street and King's Cross.

GETTING HERE

LOCATION

Meta

11-21 Canal Reach

London

N1C 4DB

Underground:

King's Cross St. Pancras Station (Circle, Hammersmith & City, Metropolitan, Northern, Piccadilly and Victoria lines) – approximately a 6–8 minute walk
Russell Square Station (Piccadilly line) – around a 12-minute walk

Train:

King's Cross Railway Station – around a 6–8 minute walk, with direct services to destinations across the UK
St Pancras International – around a 6–8 minute walk, providing Thameslink services and international connections via Eurostar

By Bus:

Several bus routes serve the King's Cross area, with stops near York Way, King's Cross Station, and along Euston Road. Nearby routes include 17, 30, 46, 73, 91, 205, 214, 259, 390, and 476, providing connections across central, north, and east London.

By Car:

We recommend using public transport where possible, as parking in the King's Cross area is limited. There are nearby public car parks, including the NCP at St Pancras International Car Park and parking facilities around the King's Cross estate.

Walking Directions:

From King's Cross St. Pancras Station, exit onto York Way and walk north towards the Regent's Canal. Continue along York Way for approximately 5–7 minutes, then turn left toward Canal Reach within the King's Cross development. 11–21 Canal Reach will be located near the canal, within the Meta campus.

WHO ATTENDS

Attracting senior level professionals from Workplace, CRE, IT, HR and Architecture & Design

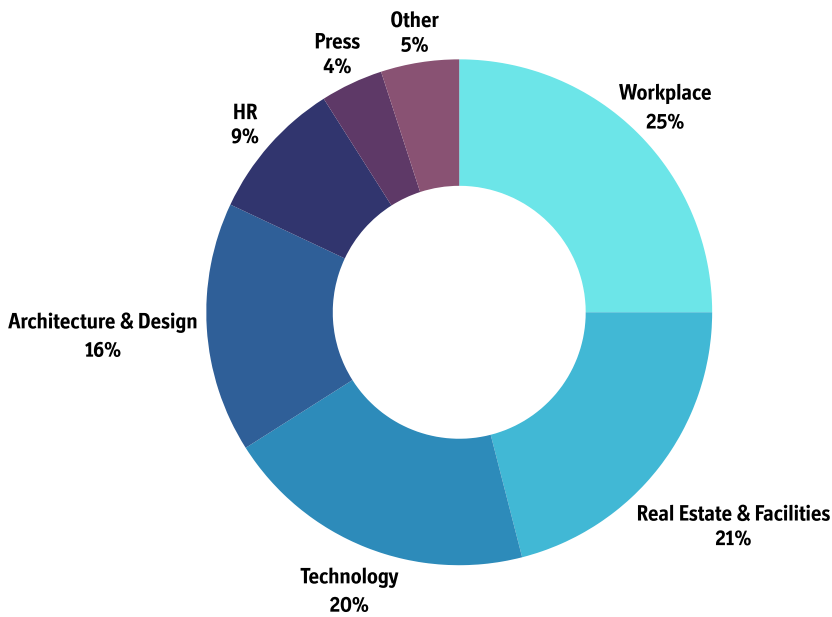

This is an event packed with exciting innovative information you can use especially if you are designing a new workplace.

VICE PRESIDENT, JPMORGAN CHASE



Very informative and up to date information that changes the way of working. Definitely a good one to go to to learn more about the workplace!

PORTFOLIO MANAGER, SHELL



BOOK NOW

WWW.WORKTECHEVENTS.COM/EVENTS/WORKTECH26-WORKTECH26-AI-DIGITAL-TECHNOLOGIES/

KEY INFORMATION

Date & Venue

When: Tuesday 9th June 2026

Where: Meta, Kings Cross, 11-21 Canal Reach

How to Book:

Visit: www.worktechevents.com/events/worktech26-worktech26-ai-digital-technologies/

Offer a Special Rate to Your Network!

Become a marketing partner for this event and qualify for a special rate for your colleagues, complimentary passes for yourself, logo exposure for your organisation, and more!

If you are part of a group that would like to attend and are looking for a joint group rate please get in touch to arrange a bespoke ticket price.

Become a WORKTECH Ambassador

We're looking for people that love the future of work and the workplace and social media. People who are willing to become part of our team and help spread the word to the masses. There will be a free event ticket available to successful applicants. Apply here: <https://bit.ly/3jiHC4b>

For more information on the above initiatives, please contact:

sally.adamson@worktechevents.co.uk



WORKTECH™

WORK / WORKPLACE / TECHNOLOGY / INNOVATION

7 St. John's Mews
13 St. John's Road, Hampton Wick
Kingston upon Thames, KT1 4AN, UK

+44 (0)20 89 77 89 20
info@unwired.eu.com

www.worktechevents.com