

WORKTECH™ Stockholm

WORK / WORKPLACE / TECHNOLOGY / INNOVATION

EXPLORE THE FUTURE OF WORK AND THE WORKPLACE

ELEMENTS, JAKOBSBERGSGATAN 24,
E114 44 STOCKHOLM

THURSDAY 6TH NOVEMBER 2025

BRONZE SPONSORS



BESPOKE SPONSOR

DREES &
SOMMER

SUPPORTED BY



WORKTECH ACADEMY

unwork



Peter Verkooijen

Conference Director,
WORKTECH Events

A warm welcome to WORKTECH25 Stockholm

WORKTECH25 Stockholm is the conference for all those involved in the future of work and the workplace as well as real estate, technology and innovation.

WORKTECH brings innovative ideas and inspiration to the workplace community through inter-disciplinary speakers and learning experience to enhance creativity and move thinking forward.

Join over 100 senior professionals from real estate, facilities, HR, technology, executive management, architecture, design and professional advisors to listen to global thought leaders, further their knowledge and share best practise and expertise.

Alongside the conference, we will have a curated innovations exhibition taking place in the breakout areas for attendees to meet with our education partners, complementing learning during the day.

On the day, there will be networking breaks, allowing attendees time to meet the other participants. After the conference closes, all delegates will be invited to continue networking at the WORKTECH drinks reception.

We hope you will be able to join us and we are looking forward to welcoming you to the event on November 6th.

Warmest regards,
Peter

CONTENTS



SPEAKERS



SESSIONS



CONFERENCE AGENDA

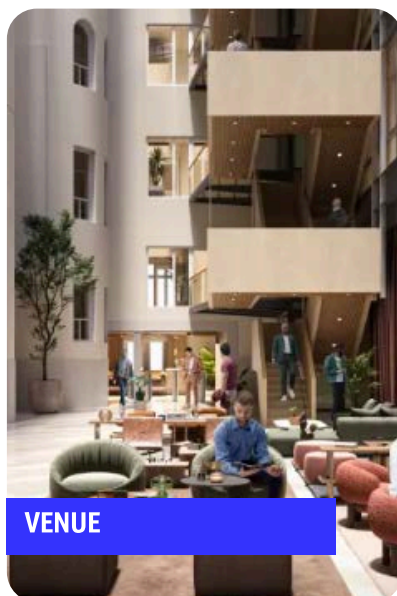

VENUE



WHO ATTENDS



KEY INFORMATION

MEET THE SPEAKERS



WORKTECH25 Stockholm will attract some of the biggest and brightest names to debate, discuss, and divulge the latest thinking on the future of work and the workplace.

The conference programme features presentations from leading international thinkers from industry and academia.

Through interdisciplinary speakers and learning experiences, we focus on bringing cutting edge ideas and inspiration to the workplace community to enhance creativity and move thinking forward. Instead of focusing on peer to peer innovation through imitation, we aim to curate a unique programme, bringing together experts in the fields of people, place and technology and relevant adjacencies to reflect on the future of work and workplace.

Alongside the conference series, the WORKTECH Academy knowledge hub explores the future of work through six key themes: people, place, technology, design, culture and innovation. Creating leading commentary, research and publications that places scientific research at the heart of key business problems. www.worktechacademy.com

Per Andersson, DeLaval
Gabriela Białkowska, WORKTECH Academy
Christina Boberg, Sandvik
Michelle Briffa, Ericsson
Torbjörn Eriksson, Tenant & Partner
Jonas Falk, Strategisk Arkitektur
Anna Gissler, AMF Fastigheter
Linda Jarnhamn, flow²thrive
Henrik Järleskog, Sodexo
Catharina Jogården, NCC
Niclas Karlsson, ICA Gruppen
Jennica Lenning, Workplacer.ai
Adrian McDonald, Epicenter Group
Hanna Mossfeldt, AMF Fastigheter
Jannica Niklasson, Telenor IoT
Fredrik Nilson, SEB
Adelie Örnhall, Iver Sverige
Ann-Christin Pilviö, Ingka Group
Tuomas Sahi, Antilooppi
Naomi Sakamoto, Gensler
Karin Ståhl, Drees & Sommer
Philip Tidd, Gensler
Asma Zahid, Telia



Niclas Karlsson, ICA Gruppen



Fredrik Nilson, SEB



Henrik Järleskog, Sodexo



Ann-Christin Pilviö, Ingka Group



Jonas Falk, Strategisk Arkitektur



Torbjörn Eriksson, Tenant & Partner



Naomi Sakamoto, Gensler



Tuomas Sahi, Antilooppi



Anna Gissler, AMF Fastigheter

SESSION HIGHLIGHTS



Key themes we will be discussing at this event include:

[Building Sustainable Offices for Hybrid Work and Collaboration](#)

Hybrid work is now embedded in Swedish work culture, fueling a flight to quality and growing demand for flexible offices, co-working and mixed-use spaces. Landmark projects such as Forskaren, Sickla Wood City, Olivin and Barkarbystaden showcase how sustainability, adaptive reuse and architectural innovation are redefining Stockholm's workplace future.

[Making Sense of New Workplace Data Streams and AI](#)

Data from digital processes, employee tracking and IoT sensors in facilities and workplace systems is growing exponentially. Aligning HR, IT and Real Estate to break down silos, apply intelligent analytics and measure real impact remains a major challenge. AI offers powerful potential to transform data overload into actionable insight, but also introduces its own set of complexities.

[Rethinking the Office for Purpose, Collaboration and Culture](#)

With hybrid, remote and networked work, the office is no longer the default workspace; it must justify a purpose as a focal point for company culture and community. Multifunctional spaces that enable meaningful meetings, social connections and memorable experiences are redefining the role of the office, ensuring that time spent together truly matters.

KEY THEMES

**BUILDING SUSTAINABLE OFFICES
FOR HYBRID WORK AND
COLLABORATION**

**MAKING SENSE OF NEW
WORKPLACE DATA STREAMS AND AI**

**RETHINKING THE OFFICE FOR
PURPOSE, COLLABORATION AND
CULTURE**

08:30 CONFERENCE OPENS

08:30 REGISTRATION AND PRE-EVENT NETWORKING

09:00 CHAIRPERSON'S WELCOME

Hanna Mossfeldt, Workplace Strategist, AMF Fastigheter



09:05 HOST WELCOME ADDRESS

Anna Gissler, Head of External Relations and Collaborations, AMF Fastigheter



09:15 NORDIC WORKPLACE INNOVATION

Anna Gissler, Head of External Relations and Collaborations at AMF Fastigheter & Adrian McDonald, CEO at Epicenter Group

How central Stockholm coworking spaces, corporate offices and innovation hubs are showcasing and shaping the future of work.



09:25 THE CHANGING CODE OF WORK: RESEARCH SHAPING THE GLOBAL WORKPLACE

Gabriela Białkowska, Future of Work Researcher and Writer at WORKTECH Academy

This session explores the emerging codes redefining how, where and why we work. As hybrid models mature and technologies such as AI and spatial intelligence reshape organisational culture, the workplace is evolving into a more adaptive, human-centred ecosystem. Drawing on WORKTECH Academy research across people, place and technology, this session highlights the key trends and transformations guiding workplace strategy and setting the agenda for the discussions ahead.



09:40 EVOLVING LEADERSHIP TO ALIGN WORKPLACE STRATEGY AND AI MATURITY

Henrik Jarleskog, Future Work Leader, Sodexo Europe, Adelie Örnhall, Chief People and Culture Officer at Iver!, Tuomas Sahi, CEO, Antilooppi & Fredrik Nilson, Head of Group Real Estate International, SEB

As distributed collaboration becomes the default, organisations face a deeper challenge; outdated leadership models and synchronous work cultures are stalling both workplace innovation and AI adoption. In this session, Henrik Jarleskog, strategic advisor to Fortune 500 executive teams, introduces a framework linking workplace flexibility to AI maturity. He reveals why companies embracing asynchronous work and empowered teams are outperforming those stuck in legacy systems. Through a dynamic panel discussion, we'll explore how leadership style, cultural readiness and operating models shape future-ready workplaces and successful AI adoption.



10:30 COFFEE BREAK AND NETWORKING

11:00 CREATING AN INTELLIGENT WORKPLACE WITH SENSORS AND AI

Per Andersson, Director Digital, Workplace, DeLaval



In the last year DeLaval has transitioned its headquarters from a traditional corridor-based layout to a modern, activity-based environment powered by technologies like Teams Rooms, Sony Nimway, Microsoft Places and Copilot. These tools enable employees to seamlessly plan their work locations, book meeting rooms and stay connected with colleagues, while generating valuable data for workplace optimisation. In this session, Per Andersson shares lessons and insights gained from evolving a legacy office into a dynamic, data-driven workplace that supports hybrid work, enhances employee experience and delivers strategic value to real estate and HR teams.

11:20 DESIGNING FOR LONGEVITY: WHAT MAKES A WORKSPACE TIMELESS

Karin Ståhl, Managing Director, Drees & Sommer, **Catharina Jogården**, Business Transformation Manager, NCC & **Linda Jarnhamn**, Founder and CEO, flow²thrive

As the forces shaping work multiply, how can we design workplaces that stay relevant, foster wellbeing and reduce the need for frequent renovation? This panel explores adaptable materials, layouts and systems that evolve without losing relevance or care for people. Which elements of today's workplace will matter in 10, 20, or 50 years? Join us to examine how the office can serve not just as a place, but as a strategic asset for thriving teams and resilient businesses.



11:50 TURNING DATA INTO VIABLE WORKPLACES – WHERE HR, IT AND REAL ESTATE CONVERGE

Niclas Karlsson, Workplace Experience Lead, ICA Gruppen, **Jannica Niklasson**, Chief HR Officer at Telenor IoT, **Michelle Briffa**, Research Intelligence Manager Real Estate at Ericsson & **Jennica Lenning**, Co-Founder & CEO of Workplac.ai

With hybrid work still evolving and not always lining up with policy, companies are shifting from simple attendance tracking to analysing what is actually done in the office and how that contributes to business goals. Making large volumes of behavioural and sensor data actionable is a challenge ICA Gruppen faced across its Swedish offices and diverse business units – retail, banking, insurance, real estate, and pharmacy – each with their distinct work modes and business needs.



12:30 LUNCH BREAK AND NETWORKING

13:30 TELIA COMPANY - ACTIVATING DATA TO DRIVE STRATEGIC CONSOLIDATION FOR HYBRID WORK

Asma Zahid, Head of PMO Group Real Estate, Telia Company & **Jonas Falk**, Partner & Interior Architect, Strategisk Arkitektur



Occupancy measurements and workplace analytics are proving to be powerful tools for enabling strategic decisions and delivering significant cost savings. Over the past three years, Telia Company has reduced its office footprint from six buildings to two in an ambitious transformation aligned with the shift to hybrid work and a renewed focus on employee experience. In this session, Asma Zahid, Head of PMO Group Real Estate at Telia, will share how the company moved beyond traditional person-to-desk ratios to embrace true activity-based working. She will outline the journey from manual entry and exit data collection to a recent proof-of-concept with digital occupancy measurement tools and how this data informed real estate strategy and space optimisation.

14:00 KEYNOTE: A WORKPLACE WHERE AI UNLOCKS COLLECTIVE INTELLIGENCE

Torbjörn Eriksson, Founder, Tenant & Partner and Worklife Group



Within a decade, all organisations will need to make the transition to be AI-augmented. Today, most AI investments focus on efficiency - doing existing work faster. But the real opportunity? Unlocking collective intelligence by simultaneous transformation of physical space, technology and human development. Organisations waste their greatest asset in meetings where insights go unspoken and psychological safety is absent. The future workplace must integrate brain-friendly environments that enable deep thinking and collaboration, and AI augmentation that makes collective intelligence accessible. Learn from the Vinnova-funded future prototype Yggdrasil - a brain-friendly meeting room with biophilic design where human intelligence, artificial intelligence and nature's intelligence converge.

14:20 CATALYZING INNOVATION: WHAT WORKPLACE RESEARCH TELLS US

Philip Tidd, Principal, Gensler & **Naomi Sakamoto**, Principal & Studio Director, Gensler



In the session, Phil Tidd & Naomi Sakamoto will share key highlights and actionable takeaways from Gensler's 2025 Global Workplace Survey, and explore how corporate real estate leaders can create high-performing workplaces for their own organizations.

14:50 COFFEE BREAK AND NETWORKING

15:10 INGKA GROUP - VIBRANT CITY, INSPIRED WORKPLACE

Ann-Christin Pilviö, Business Development Manager, Ingka Group



Ingka Group
An IKEA retailer

Join us to explore how Ingka Group is redefining the workplace with its "Neighbourhoods" concept. Ann-Christin Pilviö will share how cultural identity, activity-based design, and data-driven insights create vibrant, purposeful offices. Discover how tech, food, and occupancy monitoring come together to enhance the co-worker experience—and why Malmö sets a global benchmark for innovative workplace strategy. Learn practical ideas to inspire your own workplaces.

15:30 THE PERSON IN THE EMPLOYEE – FROM HYBRID WORK TO HUMAN SUSTAINABILITY

Christina Boberg, Facility Manager,
Sandvik



Hybrid work and AI are already part of everyday business. But what truly sets companies apart is how they support the whole person. At Sandvik, this means going beyond policies — from extended parental leave to rehabilitation trips for recovery — to create workplaces where people feel safe, seen, and supported. Drawing on attachment theory and new research on work life balance, Christina Boberg explores how emotional sustainability drives loyalty, resilience, and long term success.

15:50 CHAIRPERSON'S CLOSING REMARKS

Hanna Mossfeldt, Workplace Strategist, AMF Fastigheter



16:00 CONFERENCE CLOSE

16:00-17:00 NETWORKING DRINKS

WHO ATTENDS

Attracting senior level professionals from Workplace, CRE, IT, HR and Architecture & Design

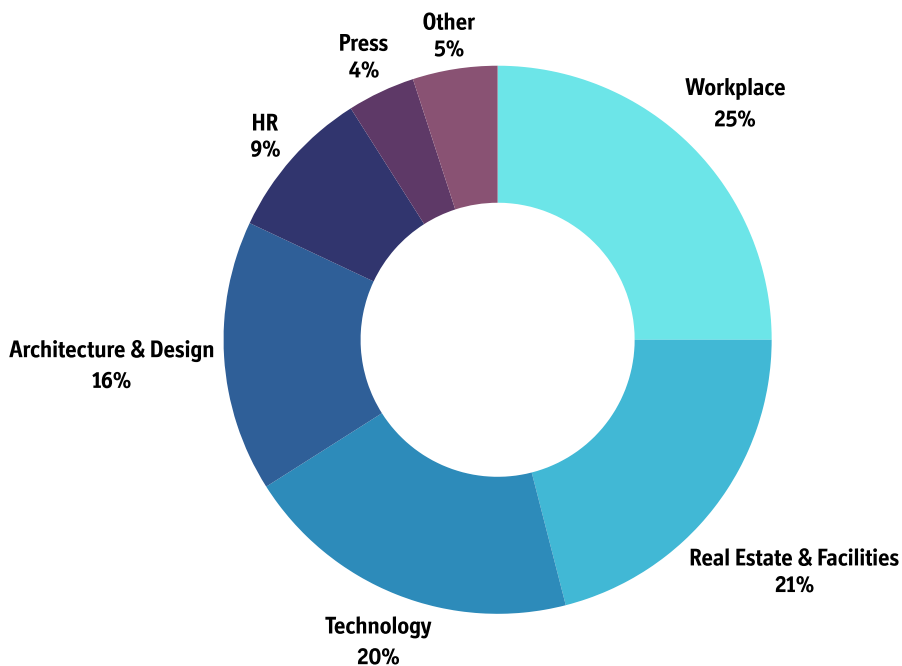

Informative, interesting views on workplace design, planning technology and workers.

WORKTECH delegate



This is an event packed with exciting, innovative information that you can use especially if you are designing a new workspace.

WORKTECH delegate, Vice President, JPMorgan Chase



LEARN MORE

www.worktechevents.com/events/worktech25-stockholm/

KEY INFORMATION

Date & Venue

When: Thursday 6th November 2025

Where: Elements, Jakobsbergsgatan 24, 114 44
Stockholm

How to book:

Visit: www.worktechevents.com/events/worktech25-stockholm/

Offer a Special Rate to Your Network!

Become a marketing partner for this event and qualify for a special rate for your colleagues, complimentary passes for yourself, logo exposure for your organisation, and more!

If you are part of a group that would like to attend and are looking for a joint group rate please get in touch to arrange a bespoke ticket price.

Become a WORKTECH Ambassador

We're looking for people that love the future of work and the workplace and social media. People who are willing to become part of our team and help spread the word to the masses. There will be a free event ticket available to successful applicants. Apply here: <https://bit.ly/3jiHC4b>

For more information on the above initiatives, please contact:

sally.adamson@worktechevents.co.uk



7 St. John's Mews

**13 St. John's Road, Hampton Wick
Kingston upon Thames, KT1 4AN, UK**

+44 (0)20 89 77 89 20

info@unwired.eu.com

www.worktechevents.com